

REV.	DESCRIPTION	DATE
A	N17'04004	Apr 12, 2017
B	MODIFY DRAWING	Aug 19, 2020

MATERIALS

- HOUSING : LCP(UL 94V-0), BLACK. $\triangle B$
- TERMINAL : COPPER ALLOY,
PLATING : GOLD PLATED ON CONTACT AREA, TIN PLATED ON SOLDER TAILS.
- SHELL : COPPER ALLOY,
PLATING : NICKEL PLATED OVERALL.

SPECIFICATION

- CURRENT RATING : 0.5 A. MAX.
- DIELECTRIC WITHSTANDING VOLTAGE :
500V AC R.M.S. FOR 1 MINUTE.
- INSULATION RESISTANCE : 100M Ω MIN. AT 500V DC.
- CONTACT RESISTANCE : 30m Ω MAX.
- OPERATING TEMPERATURE : -25°C TO +85°C.
- INSERTION FORCE : 4.5Kgf MAX.
- WITHDRAWING FORCE : 1Kgf ~ 4Kgf.

PART NUMBER INFORMATION :

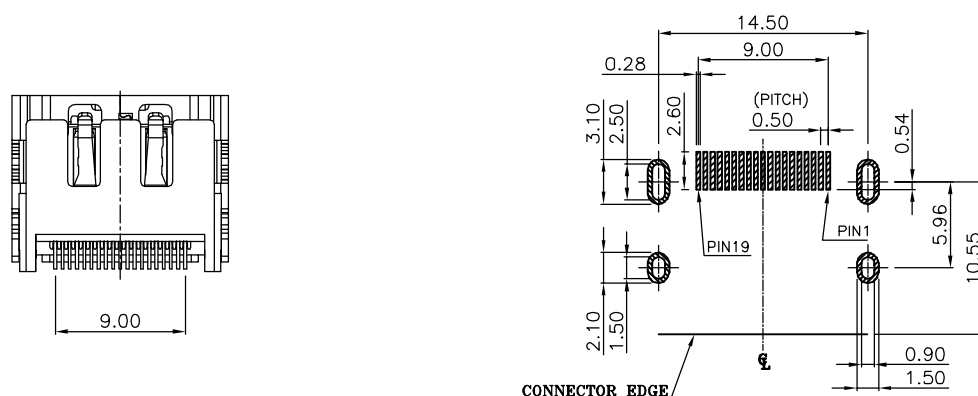
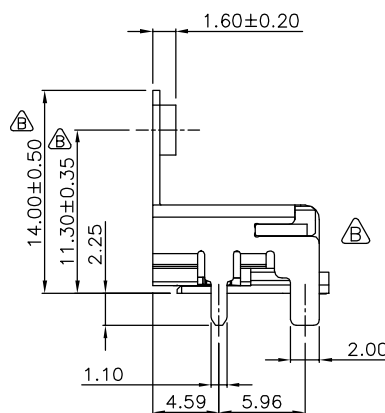
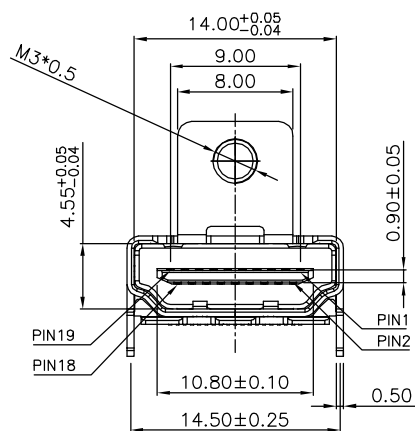
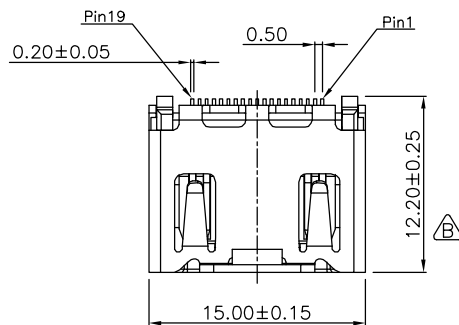
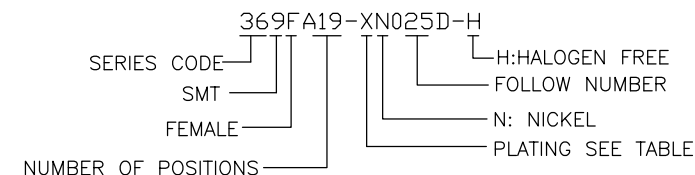

RECOMMEND PCB LAYOUT
TOLERANCE: ± 0.05 (TOP VIEW)

DESCRIPTION OF PLATING ON TERMINALS

NO.	EXPLAIN	NO.	EXPLAIN
0	GOLD FLASH	3	GOLD 15u''
6	GOLD 30u''		

TOLERANCE .0= ± 0.25 .00= ± 0.15 .000= ± 0.05 ANG.= $\pm 3^\circ$		DRAWER <i>Duan</i> CHECK <i>Stony</i> APP'D <i>Stony</i>	 ASTRON TECHNOLOGY CORP. NAME HDMI FEMALE A TYPE +FLANGE, SMT TYPE
 UNITS : mm		PRODUCT SPEC. —	
SCALE NONE	SIZE A6	SHEET 1 OF 1	REV. B