

REV.	DESCRIPTION	DATE
A	RELEASE	Mar 07, 2012

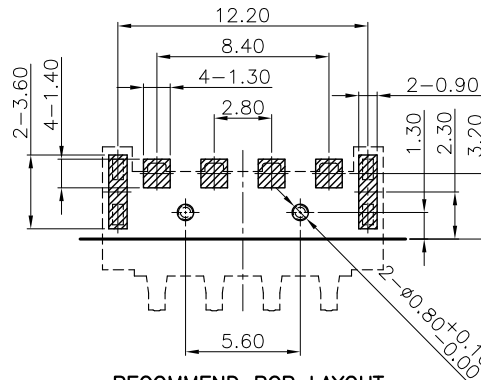
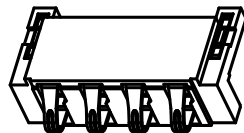
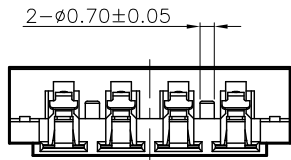

RECOMMEND PCB LAYOUT  
TOLERANCE: ±0.05  
TOP VIEW

**MATERIALS**

1. HOUSING : THERMOPLASTIC (UL 94V-0).
2. TERMINAL : BECU,  
PLATING : 3u" GOLD PLATING ON CONTACT AREA AND  
50~100u" MATTE TIN ON SOLDERING TAIL.
3. SHELL : COPPER ALLOY,  
PLATING : MATTE TIN 100u" PLATING.

**SPECIFICATION**

1. CURRENT RATING : 2.0 A. MAX.
2. DIELECTRIC WITHSTANDING VOLTAGE :  
500V AC R.M.S. FOR 1 MINUTE.
3. INSULATION RESISTANCE : 500MΩ MIN. AT 500V DC.
4. CONTACT RESISTANCE : 60mΩ MAX.
5. OPERATING TEMPERATURE : -30°C TO +85°C.

**PART NUMBER INFORMATION :**

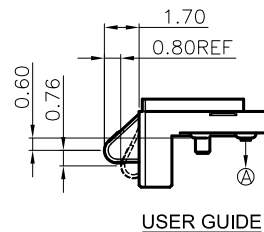
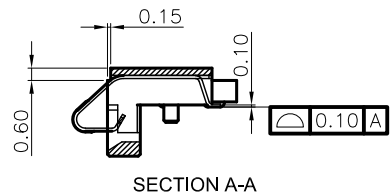
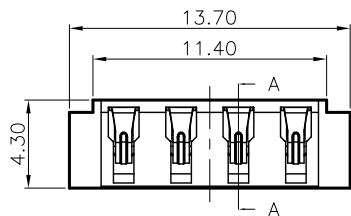
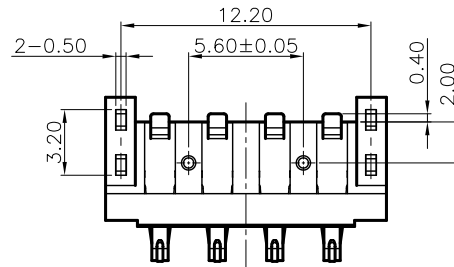
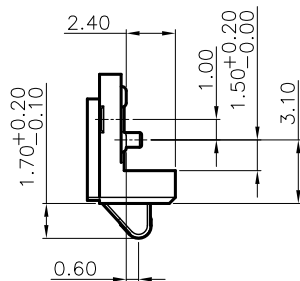
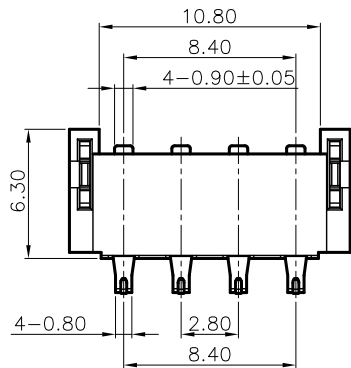
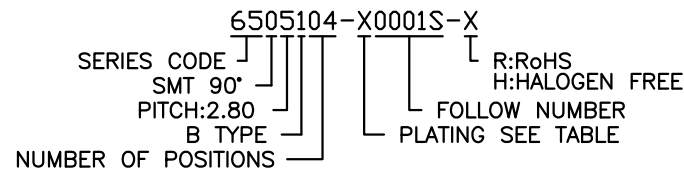

DESCRIPTION OF PLATING ON TERMINALS			
NO.	EXPLAIN	NO.	EXPLAIN
0	GOLD FLASH	3	GOLD 15u"
1	GOLD 5u"	4	GOLD 20u"
2	GOLD 10u"	6	GOLD 30u"

<b>TOLERANCE</b> .0=±0.20 .00=±0.10 .000=±0.05 ANG.=±1°	DRAWER <i>SSRV</i> CHECK <i>SSRV</i> APP'D <i>KAWK</i>	 ASTRON TECHNOLOGY CORP. NAME BATTERY 4PIN 2.8PH 4.3H DRAW NO. R6505104-X0001S-X
	PRODUCT SPEC. _____	
UNITS : mm SCALE NONE SIZE A7 SHEET 1 OF 1 REV. A		

REV.	DESCRIPTION	DATE
A	RELEASE	May. 03, 2013

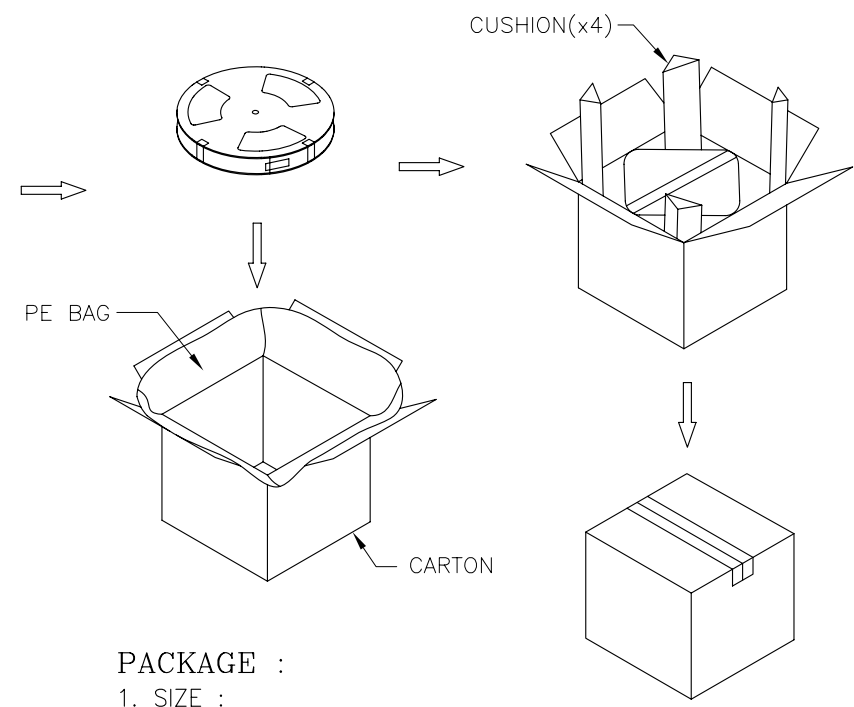
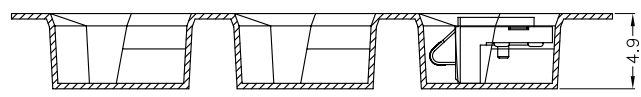
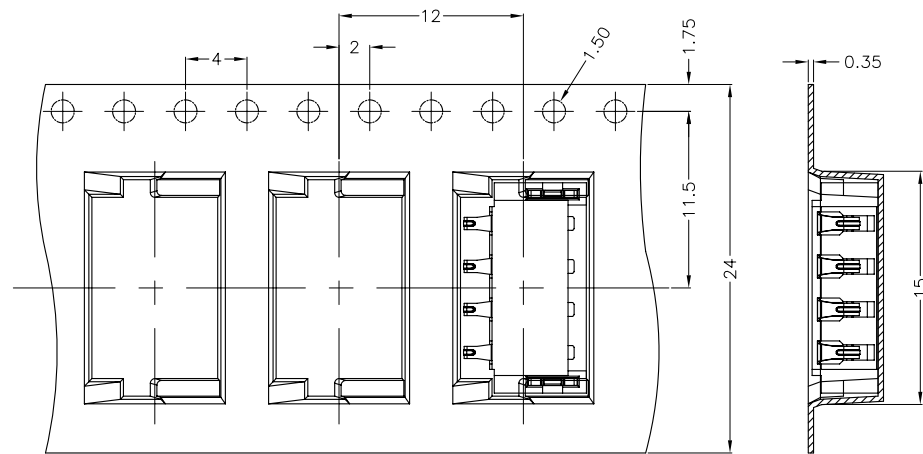
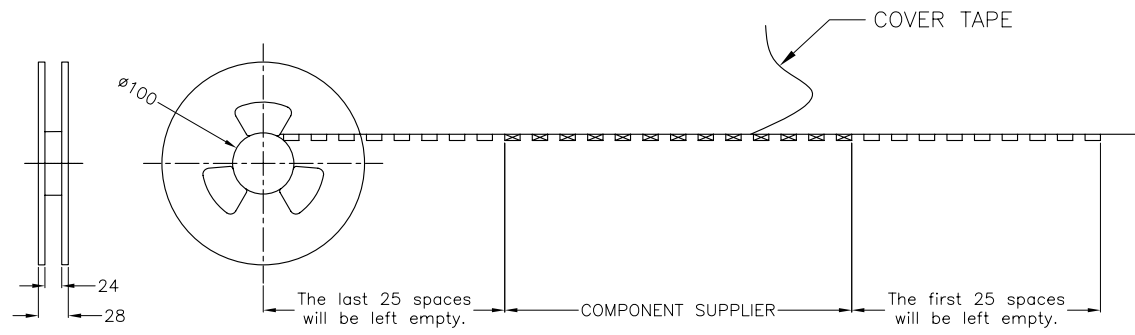

**PACKAGE :**

- 1. SIZE :  
 REEL : DIA.=330mm  
 CORTON : 350x350x360mm (LxWxH)
- 2. QUANTITY :  
 1200 PCS/REEL  
 10 REEL/CARTON = 12000PCS

TOLERANCE .0=±. .00=±. .000=±. .0000=±. ANG.=±3°		DRAWER <i>JMY</i>		<b>Astron</b> <b>WWW.ASTRON.COM.TW</b>
UNITS : mm		CHECK <i>JANFE</i>		
SCALE NONE		APP'D <i>ERTB</i>		NAME BATTERY 4PIN 2.8PH 4.3H (PACKAGE)
SIZE A4		PRODUCT SPEC. —		DRAW NO. FOR: 6505104-X0001S-X
SHEET 2 OF 3		REV. A		08031