

REV.	DESCRIPTION	DATE
A	RELEASE	Feb 10, 2010
B	11'1019	Nov 30, 2011
C	14'01XXX	JAN 13, 2014

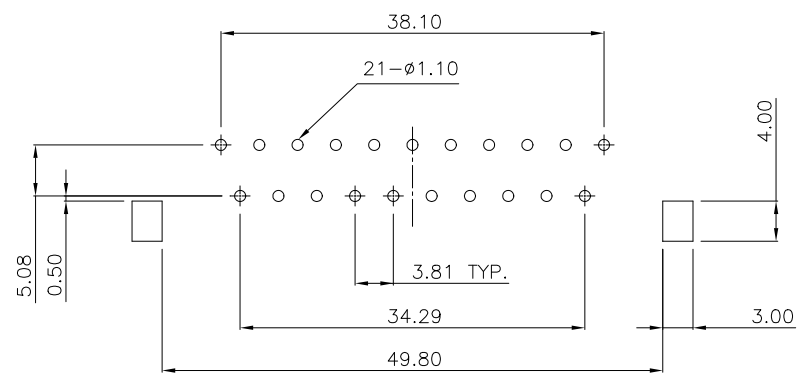
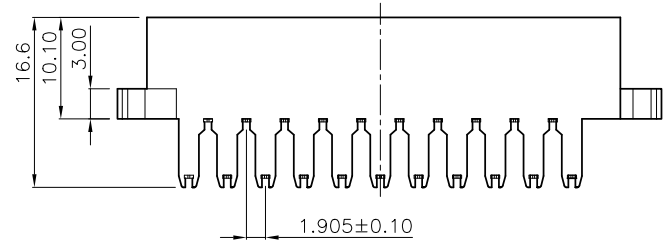
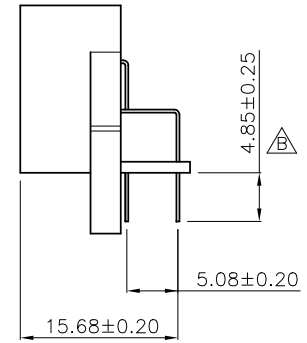
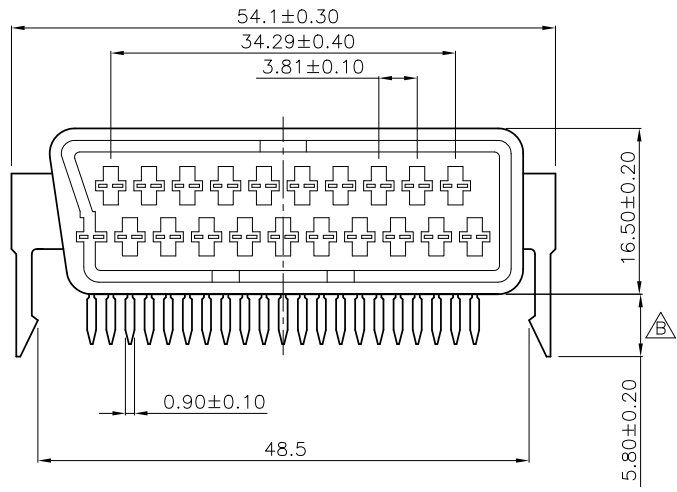

RECOMMEND PCB LAYOUT
TOLERANCE: ±0.05
TOP VIEW

MATERIALS

- 1. HOUSING : PC,BLACK
- 2. TERMINAL : C2680EH,T=0.30 TIN PLATING.
100u" min TIN OVERALL,
50u" min Nickel underplating overall

SPECIFICATION

- 1. CURRENT RATING : 3 AMP. MAX.
- 2. DIELECTRIC WITHSTANDING VOLTAGE :
1000V AC R.M.S. FOR ONE MINUTE.
- 3. INSULATION RESISTANCE : 1000M OHMS MIN.
AT 500V DC.
- 4. CONTACT RESISTANCE : 25m OHMS MAX.
- 5. OPERATING TEMPERATURE : -55°C TO +105°C.

PART NUMBER INFORMATION

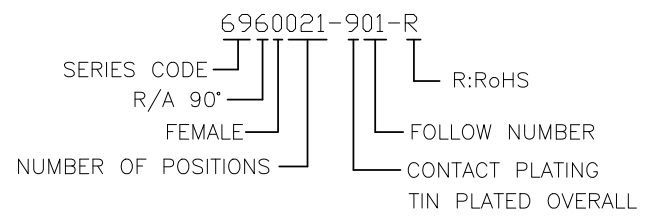

TOLERANCE .0=±0.25 .00=±0.15 .000=±0.05 ANG.=±3°		DRAWER <i>263</i>		 ASTRON TECHNOLOGY CORP.
APP'D <i>Brian</i>		CHECK <i>Flony</i>		
UNITS : mm		PRODUCT SPEC. —		DRAW NO. R6960021-901-R
SCALE NONE	SIZE A5	SHEET 1 OF 1	REV. C	