

REV.	DESCRIPTION	DATE
A	N13'12011	Dec.11.2013
B	N14'03002	Feb.22, 2014
C	N14'06010	Jun.16, 2014
D	N14'12005	Dec.03, 2014
E	N18'02001	Feb.23, 2018
F	MODIFY CAP	Jul.17, 2019
G	MODIFY FLANGE	May.11, 2020
H	MODIFY MYLAR	Mar.02, 2022

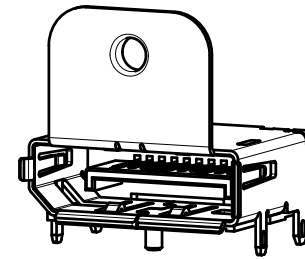
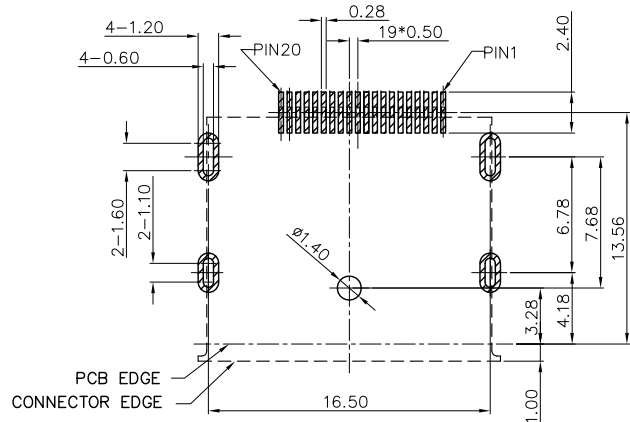
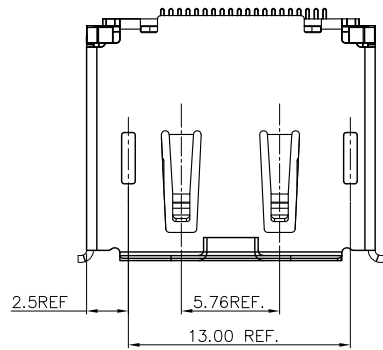

MATERIALS:

- HOUSING: LCP UL94V-0, BLACK.
- TERMINAL: COPPER ALLOY ,T=0.2mm.
PLATING: GOLD PLATED .
- SHELL: COPPER ALLOY ,T=0.4mm.
PLATING: NICKEL PLATED OVERALL.

SPECIFICATION

- CURRENT RATING : 0.5 A MAX.
- DIELECTRIC WITHSTANDING VOLTAGE :
500V AC R.M.S. FOR ONE MINUTE.
- CONTACT RESISTANCE : 30mΩ MAX.
- INSULATION RESISTANCE : 1000MΩ MIN. AT 500V DC.
- OPERATING TEMPERATURE : -25°C TO +85°C.
- SCREW LOCKING FORCE : 4.5±0.5Kg.

PART NUMBER INFORMATION:

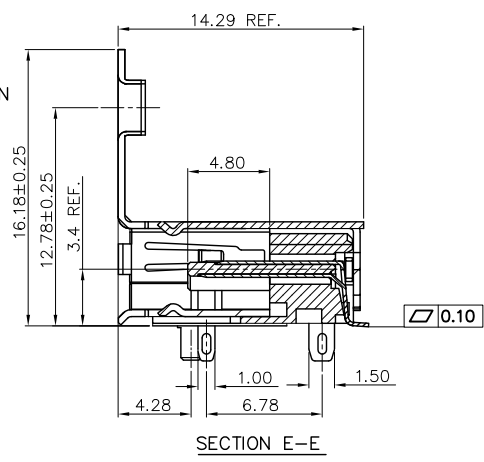
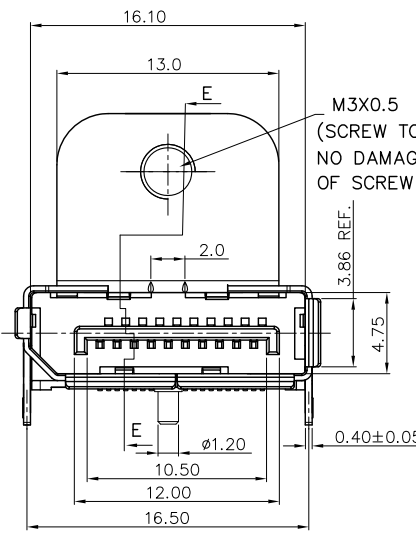
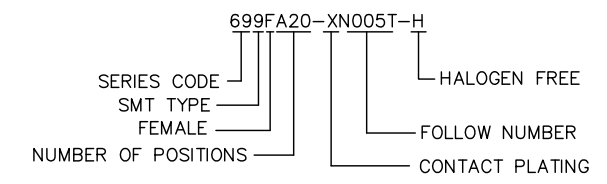

RECOMMEND PCB LAYOUT
TOLERANCE: ±0.05
TOP VIEW

PIN ASSIGNMENT					
PIN No.	SOURCE-SIDE	SINK-SIDE	PIN No.	SOURCE-SIDE	SINK-SIDE
PIN1	ML_Lane 0(p)	ML_Lane 3(n)	PIN11	GND	GND
PIN2	GND	GND	PIN12	ML_Lane 3(n)	ML_Lane 0(p)
PIN3	ML_Lane 0(n)	ML_Lane 3(p)	PIN13	CONFIG1	CONFIG1
PIN4	ML_Lane 1(p)	ML_Lane 2(n)	PIN14	CONFIG2	CONFIG2
PIN5	GND	GND	PIN15	AUX CH (p)	AUX CH (p)
PIN6	ML_Lane 1(n)	ML_Lane 2(p)	PIN16	GND	GND
PIN7	ML_Lane 2(p)	ML_Lane 1(n)	PIN17	AUX CH (n)	AUX CH (n)
PIN8	GND	GND	PIN18	HOT PLUG DETECT	HOT PLUG DETECT
PIN9	ML_Lane 2(n)	ML_Lane 1(p)	PIN19	RETURN	RETURN
PIN10	ML_Lane 3(p)	ML_Lane 0(n)	PIN20	DP PWR	DP PWR

DESCRIPTION OF PLATING ON TERMINALS			
NO.	EXPLAIN	NO.	EXPLAIN
0	GOLD FLASH	3	GOLD 15u"
6	GOLD 30u"		

TOLERANCE .0=±0.25 .00=±0.15 .000=±0.05 ANG.=±3°	DRAWER <i>BNR</i> CHECK <i>YON</i> APP'D <i>BN</i>	<p>ASTRON TECHNOLOGY CORP.</p>	
<p>PRODUCT SPEC.</p>	NAME DISPLAYPORT SMT TYPE FEMALE		
UNITS : mm		DRAW NO. R699FA20-XN005T-H	
SCALE NONE	SIZE A7	SHEET 1 OF 2	REV. H

REV.	DESCRIPTION	DATE
A	N13'12011	Dec.11.2013
B	N14'03002	Feb.22, 2014
C	N14'06010	Jun.16, 2014
D	N14'12005	Dec.03, 2014
E	N18'02001	Feb.23, 2018
F	MODIFY CAP	Jul.17, 2019
G	MODIFY FLANGE	May.11, 2020
H	MODIFY MYLAR	Mar.02, 2022

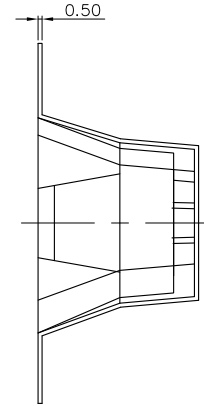
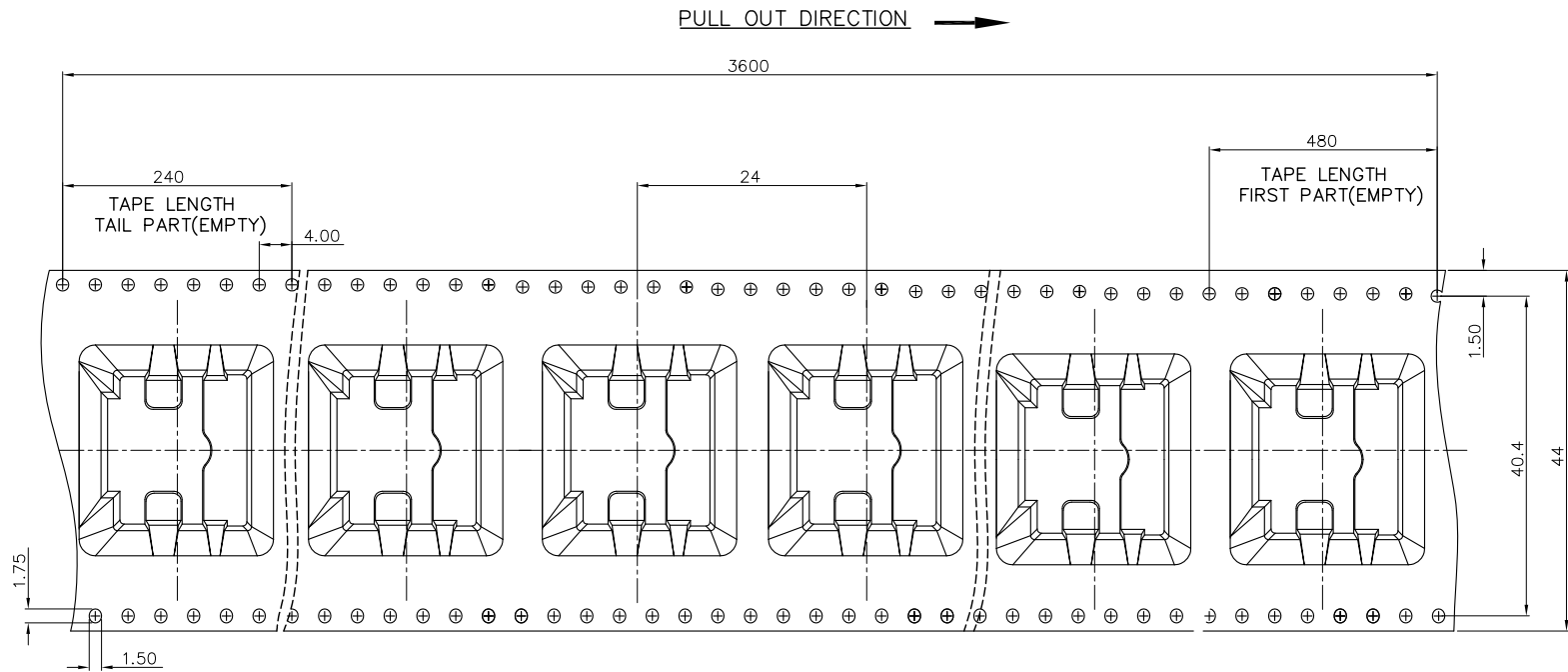

PULL OUT DIRECTION →

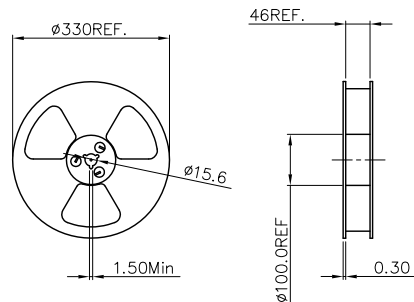

REEL FOR CARRIER TAPE

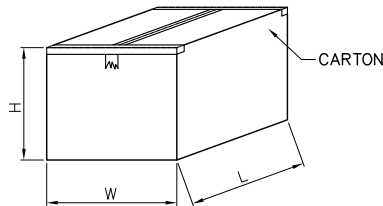
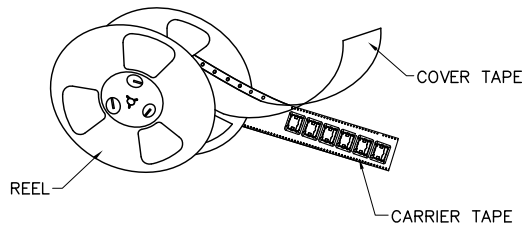

TAPE & REEL PACKAGE : MATERIALS

1. CARRIER TAPE: POLYSTYREN (PS)
2. COVER TAPE: POLYSTYREN (PS)
3. REEL: POLYSTYREN (PS)

QUANTITY

1. 90PCS PER REEL
2. 5 REEL PER CARTON(450PCS PER CARTON)
(CARTON : L=350mm, W=350mm, H=296mm)

<u>TOLERANCE</u> .0=±0.25 .00=±0.15 .000=±0.05 ANG.=±3°	DRAWER <i>Duan</i>	 ASTRON TECHNOLOGY CORP.
	CHECK <i>Duan</i>	
 UNITS : mm	APP'D <i>Stony</i>	PRODUCT SPEC.
	SCALE NONE	SIZE A7
SHEET 2 OF 2	REV. H	